

Disney FROZEN



PRINCESS CAPE

Make Your Very Own Princess Capes

Adult supervision is required for this craft.



Elsa's Magical Translucent Style Cape

You will need:

- Blue shimmering fabric (2 yards)
- White shimmering fabric (2 yards)
- White Yarn (1 yard)
- White thread
- Sewing needle

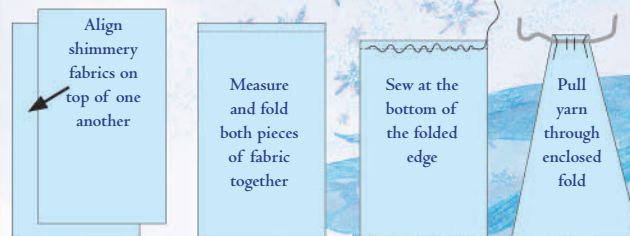

Directions:

1) Cut 2 yards of blue shimmering fabric. 2) Cut 2 yards of white shimmering fabric and align them on top of one another. 3) Measure 4 inches from the top and fold.

4) Sew at the bottom of the folded edge to create an enclosed fold. 5) Pull white yarn through the enclosed fold leaving six inches on each side to tie.



Anna's Wool Style Shawl Cape

You will need:

- Raspberry wool fabric (2 yards)
- Black ribbon (4 yards)
- Hooking style clasp
- Raspberry thread
- Sewing needle
- Hot glue gun

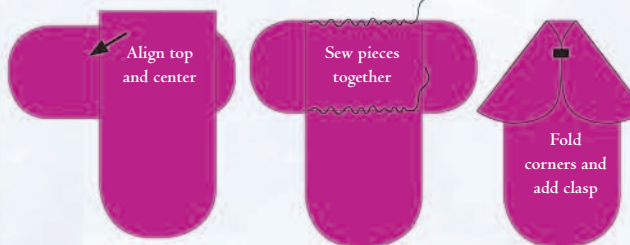

Directions:

1) Cut 1 yard of raspberry wool fabric and cut the corners on both sides to round them off. 2) Cut a second piece of raspberry wool fabric and cut the corners on one end to round them off (keep the opposite ends corners square). 3) Align at the top and center as indicated above.

4) Sew the two pieces of fabric together as indicated above. 5) Add black ribbon around the outer edge with a hot glue gun! 6) Fold the rounded corners of the shawl cape down and sew a hooking style clasp towards the top.



ON DIGITAL HD NOW AND
BLU-RAY™ COMBO PACK MAR 18





Disney
FROZEN
**SISTER
BRACELETS**

Create your very own Frozen sister bracelets for your better-than-best-friends!

You Will Need: ICY BEADS | LETTER BEADS | CLEAR STRETCHY CORD | SCISSORS | BALLOONS | WATER

Directions: Have an adult help you with this activity.

STEP 1: Cut a 10 to 12 inch length of clear stretchy cord and tie a knot 2 inches up from one end to keep your beads from slipping off.

STEP 2: String icy beads and letter beads to spell out your sister's name. Secure both ends together with a knot. (do not trim the extra length of stretch cord)

STEP 3: Gently open the balloon with one hand and carefully place your sister bracelet into the dry balloon, keeping the extra length of stretch cord outside of the balloon opening.

STEP 4: Slowly fill the balloon with cold water. Tie the balloon like a normal water balloon.

STEP 5: Place your water balloon knot-side-down on a plastic plate or bowl and put in the freezer overnight, check the balloon by gently shaking it back and forth. If you feel liquid sloshing around inside or see an air bubble moving around inside, put it back into the freezer for another day. Continue to check until it is completely frozen.

STEP 6: Place the balloon in a bowl and gently remove the outer balloon coating, try not to touch the surface of the ice to prevent melting. Put it back in the bowl and into the freezer to keep it frozen.

STEP 7: Give your bracelet gem to your sister.

STEP 8: Place the bracelet gem on a saucer or surface outdoors and admire until it melts and reveals the special better-than-best-friends bracelet!



**ON DIGITAL HD NOW
AND BLU-RAY™ COMBO
PACK MAR 18**

